

Figure 7. Parts Illustrations for Model 9910-D70

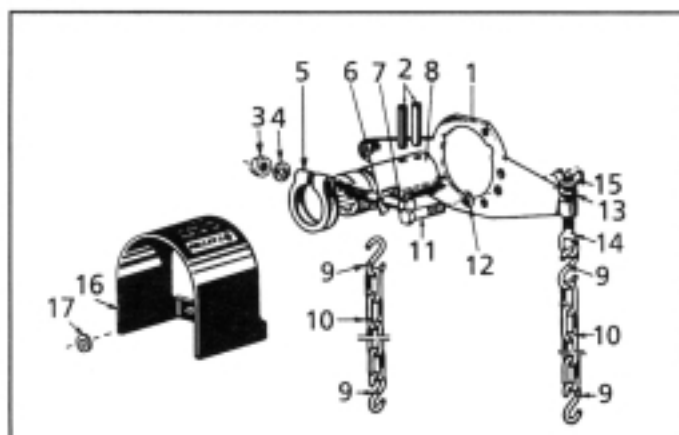

Figure 8. 9910-Kit 1708 1-3/8" Female PTO Adapter, Safety Shield, Torque Arm and Chains

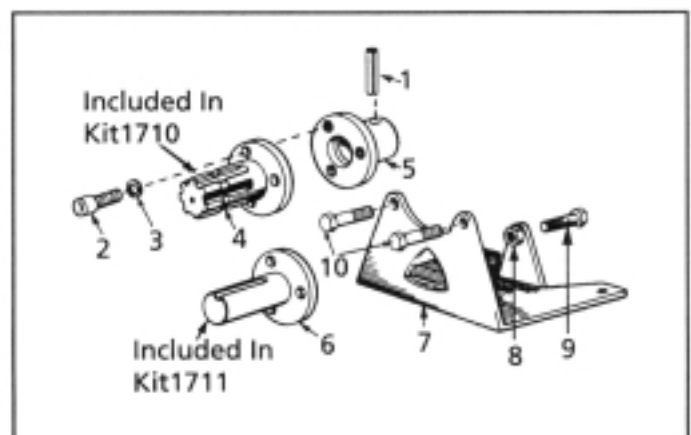

Figure 9. 9910-Kit 1710 1-3/8" Male PTO Shaft and Base Kit 9910-Kit 1711 1" Solid Shaft and Base Kit

Parts List for 9910-D70, 9910-KIT1708, 9910-KIT1711 and 9910-KIT1710

NOTE: When ordering parts, give QUANTITY, PART NUMBER, DESCRIPTION, and COMPLETE PUMP MODEL NUMBER. Reference numbers are used ONLY to identify parts in the drawing and are NOT to be used as order numbers.

Parts List for 9910-D70

REF. NO.	PART NUMBER	DESCRIPTION	QTY. REQ'D.
1	9910-550010	Pump Body	1
2	9910-550101	Right Head	1
3	9910-550102	Left Head	1
4	9910-550150	Manifold	1
5	9910-559200	Accumulator manifold	1
6	9910-580370	Plate	2
7	9910-550080	Diaphragm (Buna, Optional)	2
7a	9910-550085	Diaphragm (Desmopan)	2
8	9910-550110	Sleeve	2
9	9910-550120	Piston	1
10	9910-320030	O-Ring	4
11	9910-759051	Complete Valve	4
12	9910-180152	Nut	10
13	9910-580360	Diaphragm Pin	2
14	9910-550880	Ring Nut	1
15	9910-580040	Elbow	1
16	9910-550370	Elbow	1
17	9910-550350	O-Ring	1
18	9910-550340	Threaded adapter	1
19	9910-550310	Roller bushing	1
20	9910-390290	O-Ring	7
21	9910-550300	Air Valve	1
22	9910-650542	Gasket	1
23	9910-550680	Bolt	4
24	9910-550233	Accumulator head	1
25	9910-550190	Accumulator diaphragm	1
26	9910-550057	Sight glass cap	1
27	9910-550040	O-Ring	1
28	9910-550030	Oil sight glass	1
29	9910-390442	Nut	2
30	9910-180101	O-Ring	1
31	9910-200391	Circlip	2
32	9910-550470	Bushing	1
33	9910-550070	Spacer	1
34	9910-550060	Roller Bushing	1
35	9910-550170	Crankshaft	1
36	9910-550280	Roller bushing	2
37	9910-550140	Cylinder	1
38	9910-550160	Spacer	1
39	9910-550491	Seal Ring	1
40	9910-650920	O-Ring	1
41	2406-0023	Plug	1
42	9910-550332	Washer	2
43	9910-740290	O-Ring	1
44	9910-961341	Washer	4
45	9910-450120	Threaded adapter	1
46	9910-550870	Ring nut	1

Parts List for 9910-KIT1708

1-3/8" Female PTO Adapter, Safety Shield, Torque Arm, and Chains

REF. NO.	PART NUMBER	DESCRIPTION	QTY. REQ'D.
1	9910-380271	Torque Arm	1
2	9910-550290	Roll Pin	2
3	9910-320130	Nut	1
4	9910-320131	Washer	1
5	9910-500160	Collar	1
6	9910-500171	Lock Retaining Washer	1
7	9910-320170	Bolt (12MAx75)	1
8	9910-550250	Female Splined Shaft	1
9	9910-320650	Chain 'S' Hook	4
10	9910-320640	Chain	2
11	9910-620472	Bolt	2
12	9910-200231	Washer	5
13	9910-320620	Washer	1
14	9910-320630	Bolt	1
15	9910-320610	Wing Nut	1
16	2840-0028	Safety Shield (with Kit 1708)	1
17	2270-0004	Washer	4

Parts List for 9910-KIT1710 & 1711 Shaft Kit

REF. NO.	PART NUMBER	DESCRIPTION	QTY. REQ'D.
1	9910-550290	Roll Pin	2
2	9910-620470	Bolts	3
3	9910-200231	Washer	3
4	9910-620240	1 3/8" Male 6 Spline PTO Shaft	1
5	9910-550510	Adapter	1
6	9910-621600	1" Solid Shaft	1
7	9910-580080	Base	1
8	9910-580190	Nut	1
9	9910-540300	Bolt (10MAx30)	1
10	9910-620472	Bolt	2

Replacement Parts Kits



9910-KIT2361

Buna Diaphragms	
Ref. No	Qty.
7	2



9910-KIT2363

Desmopan diaphragms	
Ref. No	Qty.
7a	2



9910-KIT2364

Valves	
Ref. No	Qty.
10	4
11	4



9910-KIT2365

O-Rings	
Ref. No	Qty.
10	4
17	1
20	7
22	1
27	1
30	1
40	1
43	1